



# **MODEL 08520-220 220V, 50/60Hz, 2HP 20-GALLON WET/DRY VACUUM**



## **Operating Maintenance Instructions**

Elliott Tool Technologies Ltd • 1760 Tuttle Avenue • Dayton, Ohio 45403 U.S.A.  
Phone: +1 800 332 0447 • +1 937 253 6133 • Fax: +1 937 253 9189

Elliott Tool Technologies UK Ltd • Broadstone Hill • Old Chalford • Chipping Norton • OXON • OX7 5QL • England  
Phone: +44 (0) 1608 672815 • Fax: +44 (0) 1608 672810

# **TABLE OF CONTENTS**

Introduction.....	2
Operating Instructions .....	3 & 4
Parts List.....	5 through 7
Filter Set-Up Procedure.....	8
Tool Kit And Replacement Parts .....	9

# INTRODUCTION

Thank you for purchasing this Elliott product. More than 100 years of experience have been employed in the design and manufacture of this machine, representing the highest standard of quality, value and durability. Elliott tools have proven themselves in thousands of hours of trouble free field operation.

If this is your first Elliott purchase, welcome to our company; our products are our ambassadors. If this is a repeat purchase, you can rest assured that the same value you have received in the past will continue with all of your purchases, now and in the future.

The Elliott 08520-220 220V Wet/Dry Vacuum has been designed for cleaning tubes in the following types of equipment:

Heat Exchangers

Condensers

Chillers

Boilers

Evaporators

Air Conditioners

If you have any questions regarding this product, manual or operating instructions, please call Elliott at +1 800 332 0447 toll free (USA only) or +1 937 253 6133, or fax us at +1 937 253 9189 for immediate service.

# **OPERATING INSTRUCTIONS**

## **Inspection**

Thoroughly inspect your machine for any shipping damage. Your machine has already been thoroughly tested at Elliott Tool Technologies prior to shipping.

## **Maintenance**

Lubrication of this motor is not required as it is equipped with sealed bearings.

Always keep the air cooling intake screen free, not allowing any restriction of airflow. Airflow restriction will overheat and damage the motor.

To prolong the life of the H.E.P.A. filter, empty, clean, and replace bags and filters regularly as described in the following sections.

## **Safety Instructions**

Read all safety instructions before using!

1. Electrical shock could occur if used outdoors or on wet surfaces.
2. Always store machine indoors in a dry area. If machine is dropped in water or left in rain, it should be serviced by an authorized service technician prior to plugging the unit in.
3. Prior to plugging in machine, always inspect cord for cuts and exposed wires. If these problems are found, return the machine to an authorized service technician.
4. Never use the cord as a handle, or pull the machine by using the cord.
5. Never unplug this machine or any other electrical appliance by pulling on the cord.
6. Do not wrap the cord around the dome. Wrapping the cord around the dome will restrict the motor from exhausting properly and will result in overheating and damaging the motor.
7. Keep hair, fingers, and other objects away from all moving parts and openings on this machine.
8. This vacuum cleaner should never be used in explosion-hazardous areas or to pick up combustible or flammable liquids such as gasoline, etc.
9. Never leave the machine unattended when plugged in or running.
10. Always have the switch in the OFF position before unplugging the unit.
11. Do not operate this machine with any of the openings blocked; always keep these areas free of lint and dust or any other particles that could reduce the airflow.

12. Never operate or plug in this machine or any other electrical appliance with wet hands or when standing in water.
13. This machine should never be operated without the proper filters installed in the manner described in the following pages of this manual.
14. This machine should never be serviced by anyone other than an authorized technician.
15. Use only original replacement parts and attachments.

## **Operation**

1. Plug in power cord.
2. On/off switch is located on the motor dome.
3. Make sure the vacuum lid is securely in place on the vacuum tank.
4. Place metal hose cuff end of hose into the vacuum intake and secure it with the intake knob.
5. Turn on the unit.
6. Place desired vacuum tools into the plastic hose cuff.
7. When picking up dry materials, the foam filter bag and white Dacron bag should be used.
8. When picking up wet materials, use only the foam filter bag.

# PARTS LIST

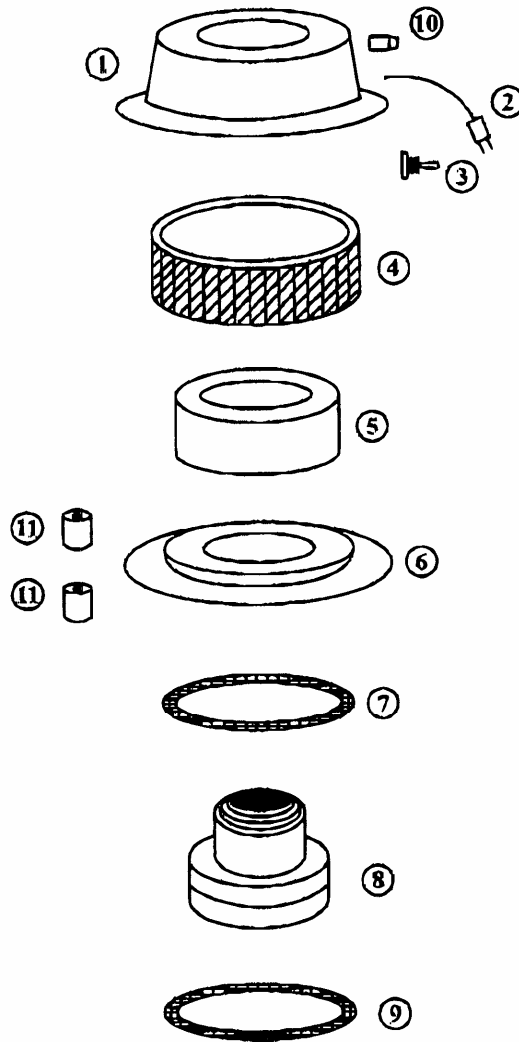

Reference	Description	Qty. Req.
1	Motor Dome	1
2	Power Cord	1
3	Toggle Switch	1
4	Dome Felt	1
5	Foam Ring	1
6	Motor Hold Down	1
7	Upper Motor Gasket	1
8	Motor	1
9	Lower Motor Gasket	2
10	Stain Relief	1
11	Large Spacer	4

# PARTS LIST

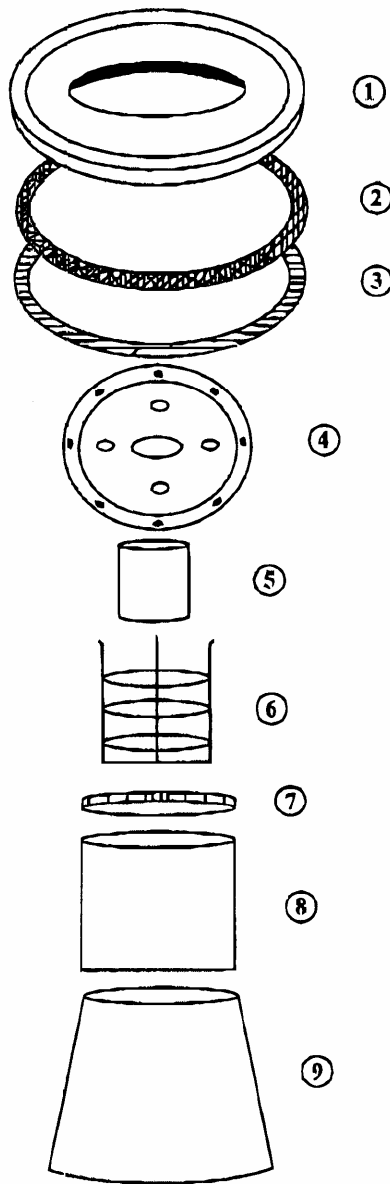

Reference	Description	Qty. Req.
1	Lid W/Mtg. Plate & Gasket	1
2	Lid Gasket	1
3	Float Mounting Plate	1
4	Float	1
5	Float Cage	1
6	Bag Clamp	1
7	Foam Filter Bag	1
8	Dacron Filter Bag	1

# PARTS LIST

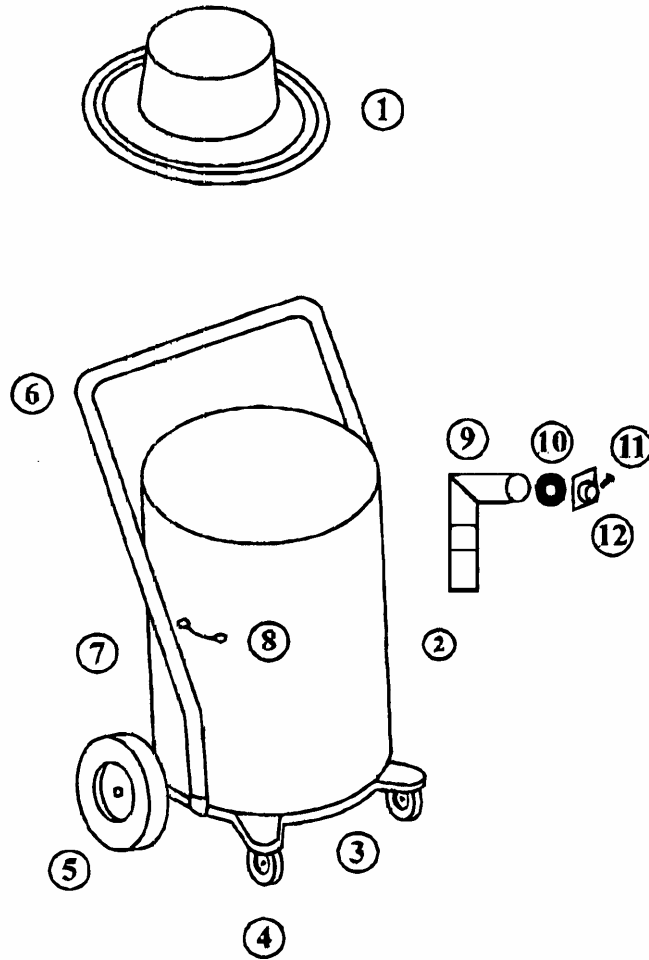

Reference	Description	Qty. Req.
1	Motor And Lid Assembly	1
2	20 Gallon Poly Tank	1
3	Cart	1
4	Front Caster	2
5	Rear Wheel	2
6	Tank Handle	1
7	Handle Clamp	2
8	Side Handle	2
9	Down Tube Elbow	1
10	Intake Gasket	1
11	Intake	1
12	Intake Knob	1
13	Lid Latch (Not Shown)	2



# **FILTER SET-UP PROCEDURE** **WET PICK-UP**

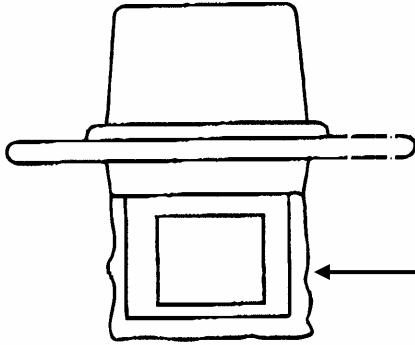

Black Foam Filter Bag  
(The only filter used for wet pick-up)

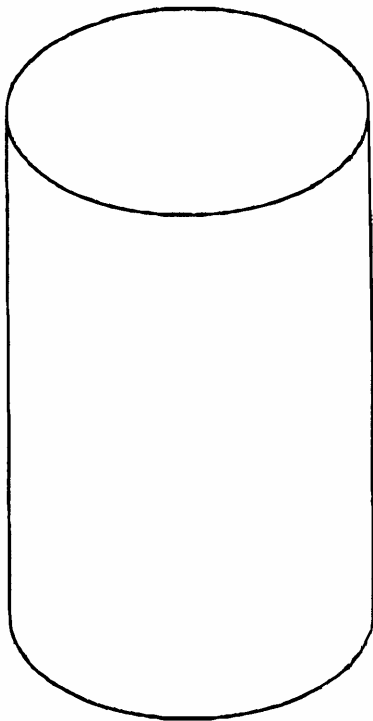

Tank Assembly



**WARNING**



Always Use The Black Foam Filter Bag.

Wet Pick-Up Without The Black Foam Filter Bag Properly In Place  
Will Cause Motor Damage.

# TOOL KIT AND REPLACEMENT PARTS FOR WET/DRY VACUUM

Part Number	Description
08521	Wet/Dry Tool Kit Includes:
	(1) 1-1/2" x 10 Ft. Hose Assembly
	(1) 1-1/2" Gulper Tool
	(1) 3" Round Dust Brush
	(1) 11" Crevice Tool
	(1) 1-1/2" Squeegee Tool
	(1) Two-Piece Double-Bend Aluminum Wand
08509	Cloth Filter Bag (washable)
08510	Paper Filter Bag (3 per pkg.)
08512	Hose Adapter
08522	1-1/2" x 10 Ft. Hose Assembly
08523	Gulper Tool
08524	3" Round Dust Brush
08525	11" Crevice Tool
08526	Squeegee Tool

Elliott offers a complete line of precision tube tools, including:

***tube  
expanders***

- Boiler Expanders
- Heat Exchanger Expanders
- Condenser Expanders
- Refinery Expanders

***tube rolling motors  
& torque controls***

- Electric
- Pneumatic

***tube  
cleaners***

- Air & Water Driven Motors  
(Internal/External Drives)
- Jiffy Guns  
("Shoot-Thru" Devices)
- Roto-Jet  
(Rotating Flex Shaft)

***additional  
products***

- Tube and Joint Testers
- Tube Plugs  
(High & Low Pressure)

***retubing  
tools***

- Tube Gauges
- Tube Cutters
- Manual Tools
- Spear Type Tube Pullers
- Collet-Type Tube Pullers
- CYCLGRIP Tube Extractors
- Grooving Tools
- End-Prep Tools

***metal working  
products***

- Back Chamfering Tools
- Carbide Roller Burnishing Tools
- Diamond Burnishing Tools
- Elliptical Deburring Tools
- Fine Boring Tools
- Internal Recessing Tools
- Magic Vise
- Mechanical Joining Tools
- Roller Burnishing Tools
- Single Blade Reamers



[www.elliott-tool.com](http://www.elliott-tool.com)